



These diaphragm pressure switches are IP 55, and suitable for a variety of applications such as: food industry, cannery, pharmaceutical, petrochemical, conventional and nuclear power station. They withstand the most unfavourable working conditions, caused by either the process fluid aggressiveness or high ambient temperature.

3.25 - Standard Model

Ranges: 0...40 mbar / 0...600 mbar.

Electrical specifications: N. 1 SPDT microswitches. (see microswitches table)

Differential: fixed.

Ripeatability: $\leq 1\%$ of the full setting value.

Set point adjustment: internal, micrometric adjustable.

Protection: IP 55 as per IEC 529, UNI 8896.

Electrical wiring: terminal screw, directly on microswitch.

Earth contacts: N. 1 internal, N. 1 external.

Process temperature: $+212^{\circ}\text{F}$ max (100°C).

Ambient temperature: $-13...+149^{\circ}\text{F}$ ($-25...+65^{\circ}\text{C}$).

Thermal drift: $\leq 0,027\%$ / $^{\circ}\text{F}$ ($\leq 0,05\%$ / $^{\circ}\text{C}$).

Process connection: AISI 316 st.st.

Elastic element: AISI 316 st.st. diaphragm.

Gasket: PTFE

Case: aluminium, blue polyurethane painted.

Cover: aluminium, beige polyurethane painted.

Tag: stainless steel, silk-screen painted.

Weight: 6.61 lbs (3 kg).

Setting range	Test pressure	Differential 1 micro (1)
de 5 à 40 mbar	0,5 bar	4 mbar
de 5 à 60 mbar	0,5 bar	4 mbar
de 5 à 100 mbar	0,5 bar	4 mbar
de 8 à 160 mbar	0,5 bar	6 mbar
de 8 à 250 mbar	1 bar	6 mbar
de 15 à 400 mbar	1 bar	10 mbar
de 15 à 600 mbar	1 bar	10 mbar

(1) differential and minimum set-point values for microswitches cod. I, N, S, U are 300% of those shown in table.

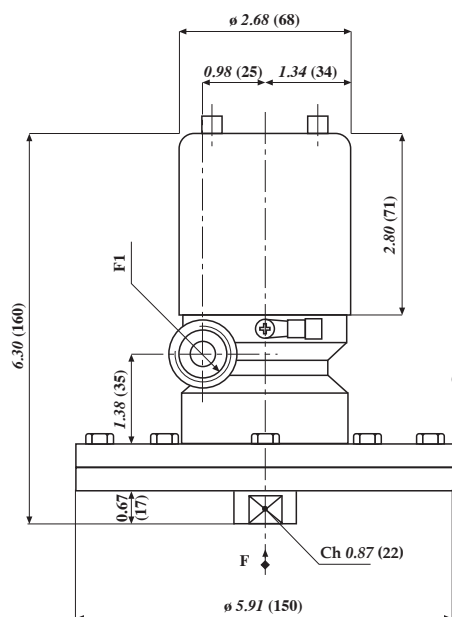

dimensions : inches (mm)

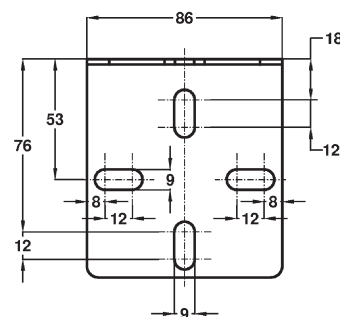
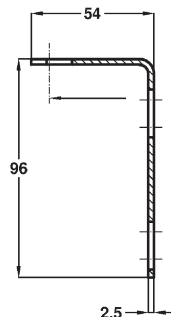

F1
1 - R 1/2-ISO 7/1
3 - 1/2-14 NPT
P11 - cable gland

F
43F - R 1/2-18 NPT F
43M - 1/2-14 NPT
41M - G 1/2 B

Set-point adjustment

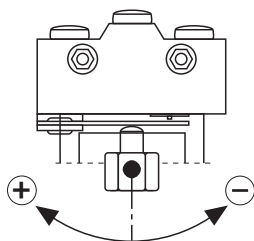

MICROSWITCHES ohmic load

Single	Type	250	125	24
		Vac	Vac	Vdc
C	std.	15A	15A	0,1A
G	SPLASH	15A	15A	0,1A
I	goldplated		1A	0,1A
M	inert gas filled	15A	15A	0,1A
N	goldplated and inert gas filled		1A	0,1A
S	SPLASH VDC	15A	15A	6A
U	inert gas filled VDC	15A	15A	6A

OPTIONS

P02 - Degreasing for oxygen
S16 - Wall mounting bracket
T01 - Tropicalisation
V20 - Epoxy painting

"HOW TO ORDER" SEQUENCE

Section / Model / Set-point Adjustment / Microswitch / Electrical connection / Process connection / Options
 3 25 C, G 1 41M P02...V20
 I, M 3 43M
 N, E P11 43F
 S, U